

FLOORPLAN SKETCH

Borrower:	File No.: 6 Quail Hill Court
Property Address: 6 Quail Hill Court	Case No.:
City: Greenville	State: SC
Lender: Agent: Sharon Wilson - Wilson Associates	Zip: 29607

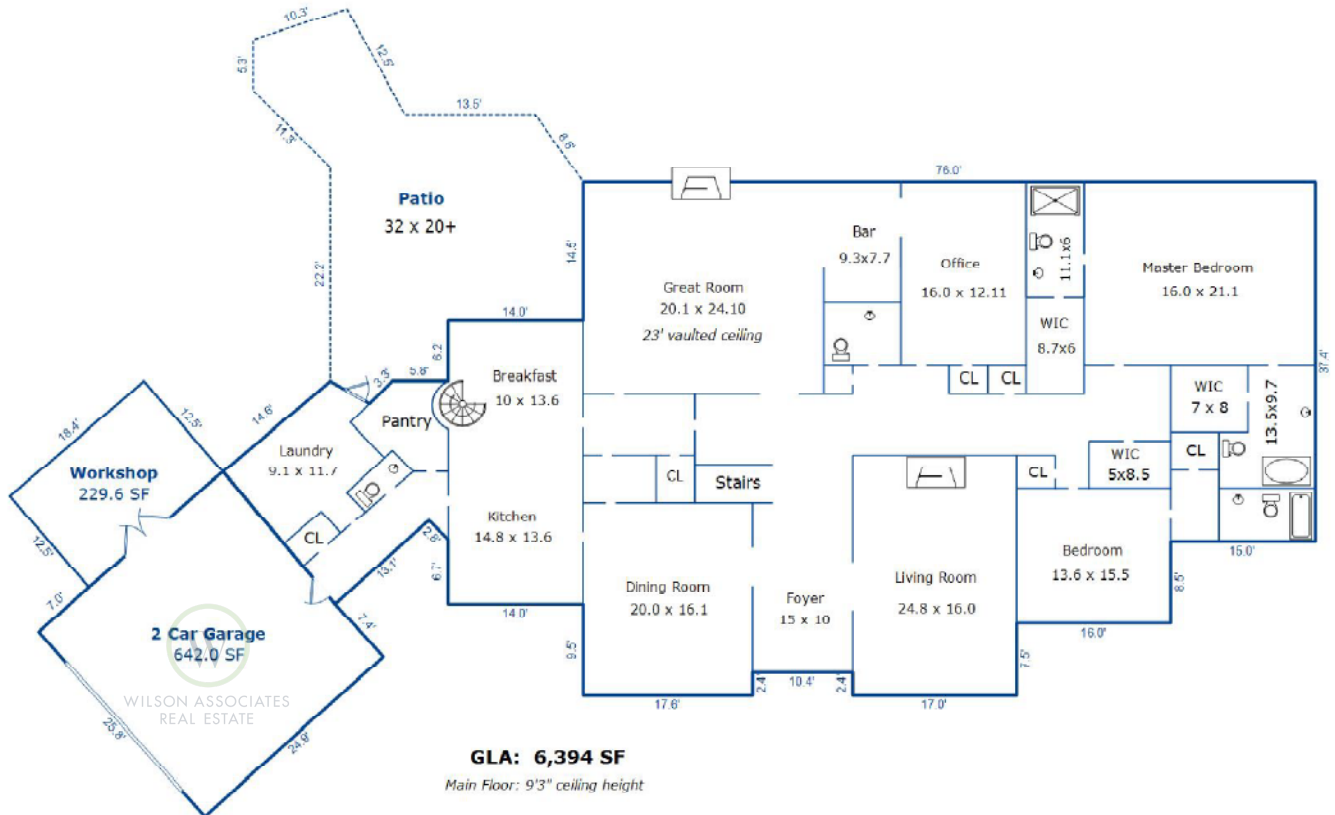

Sketch by Apex Sketch

AREA CALCULATIONS SUMMARY					AREA CALCULATIONS BREAKDOWN					
Code	Description	Factor	Net Size	Perimeter	Net Totals	Name	Base x	Height x	Width =	Area
GLA1	First Floor	1.0	4429.5	337.4	4429.5	First Floor		53.4 x	17.0 =	907.8
GAR	2 Car Garage	1.0	642.0	101.5	642.0			45.9 x	16.0 =	734.4
OTH	Workshop	1.0	229.6	61.7	229.6			51.0 x	28.0 =	1428.0
P/P	Patio	1.0	766.5	132.2	766.5			37.4 x	15.0 =	561.0
								17.6 x	2.4 =	42.2
								29.4 x	14.0 =	411.6
							0.5 x	15.6 x	5.1 =	39.5
							0.5 x	13.3 x	4.4 =	29.2
								15.6 x	4.7 =	73.0
							0.5 x	5.7 x	1.8 =	5.0
							0.5 x	3.3 x	0.2 =	0.3
								3.3 x	1.8 =	6.1
								11.4 x	1.9 =	21.1
							0.5 x	6.6 x	0.3 =	1.0
							0.5 x	6.1 x	3.2 =	10.0
							0.5 x	2.6 x	0.1 =	0.2
	Net LIVABLE			(rounded)	4,430	10 addl items 26 total items			(rounded)	4,430

FLOORPLAN SKETCH

Borrower:	File No.: 6 Quail Hill Court
Property Address: 6 Quail Hill Court	Case No.:
City: Greenville	State: SC Zip: 29607
Lender: Agent: Sharon Wilson - Wilson Associates	

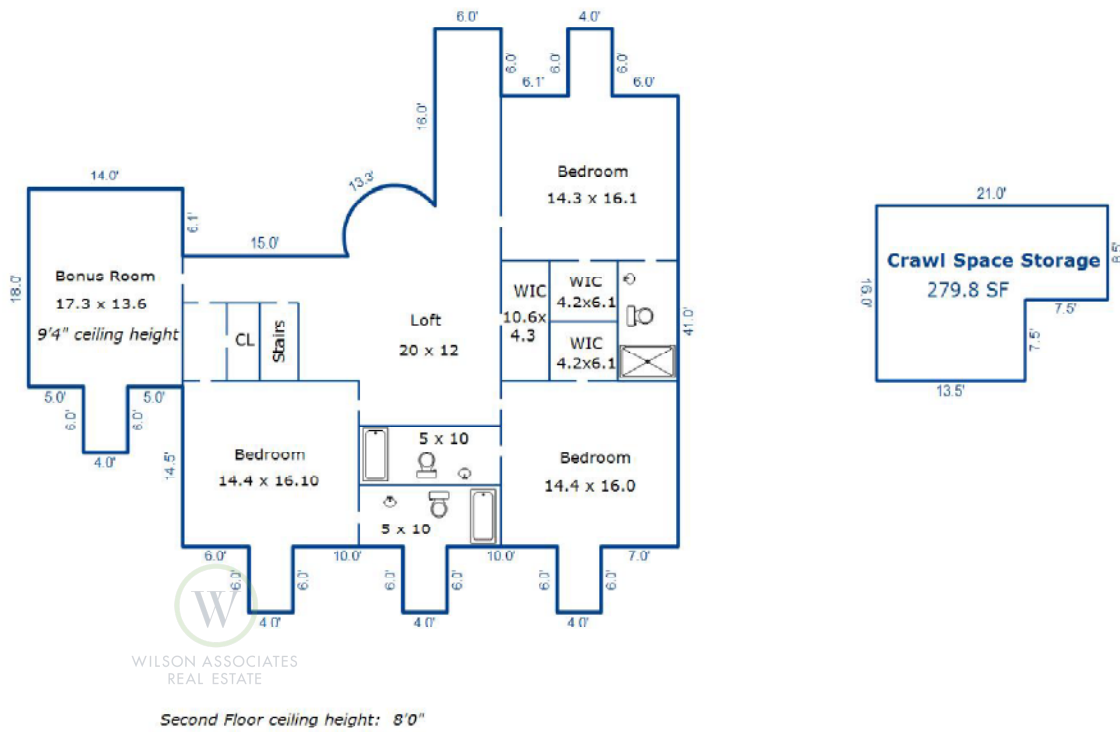

Sketch by Apex Sketch

AREA CALCULATIONS SUMMARY						AREA CALCULATIONS BREAKDOWN				
Code	Description	Factor	Net Size	Perimeter	Net Totals	Name	Base x	Height x	Width =	Area
GLA2	Second Floor	1.0	1964.7	285.0	1964.7	Second Floor		6.0 x	4.0 =	24.0
OTH	Crawl Space Stor	1.0	279.8	74.0	279.8			18.0 x	14.0 =	252.0
								6.0 x	4.0 =	24.0
								6.0 x	4.0 =	24.0
								6.0 x	4.0 =	24.0
								6.0 x	4.0 =	24.0
								26.4 x	13.9 =	367.0
							0.5 x	9.1 x	4.0 =	18.2
								20.6 x	6.0 =	123.6
								26.4 x	15.0 =	396.0
								41.0 x	16.1 =	660.1
						Curve		9.1 @	165° =	27.9
	Net LIVABLE			(rounded)	1,965	12 total items			(rounded)	1,965